

# LEDpod 40 Square Installation Instructions

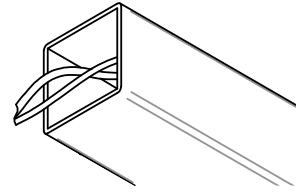

**1** Make sure drilled holes are deburred and excess swarf is removed from railing.

**2** Feed through appropriate wires (0.75-1.5mm<sup>2</sup>).

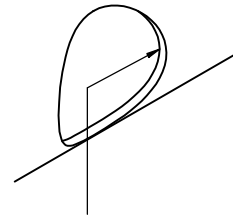
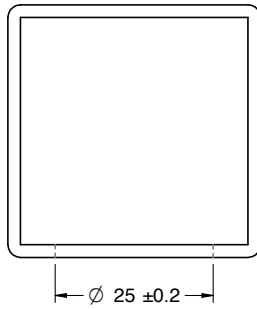
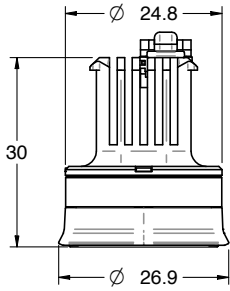
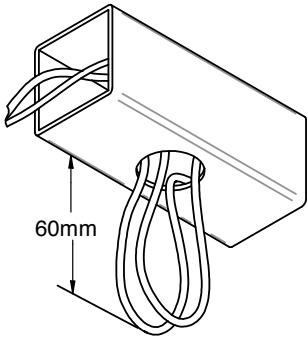

**3** Pull a loop of wire through hole.

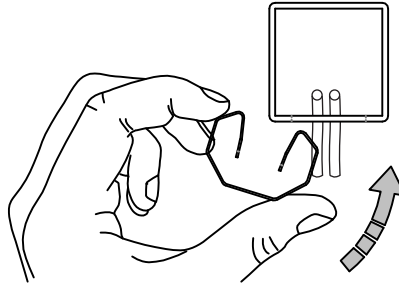

**4** Rotate retaining clasps in as shown.

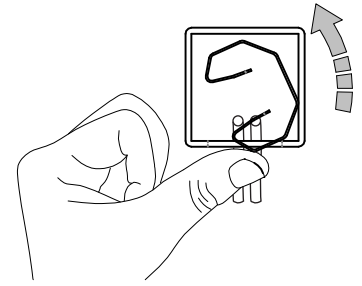

**5** Apply pressure as shown to deform clasp into place in a circular motion.

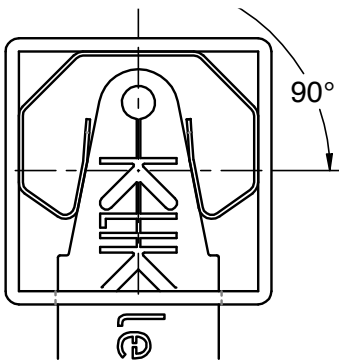

**6** Fit clasp into place until the clamping ends are equally centred over the hole. Use tool to centre clasp until equally pressure can be felt and inspect by eye.

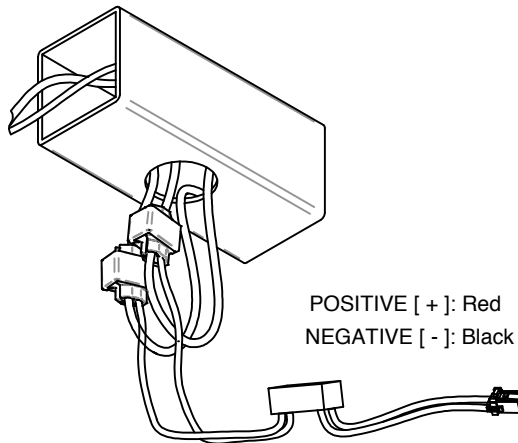

**7** Install Scotchlok connectors to the 18-16 AWG (0.75-1.5) red and black wires. Connect the corresponding colour wires of the Driver to the Scotchloks and assure the clamp is secured. Max wire insulation 3.5mm OD

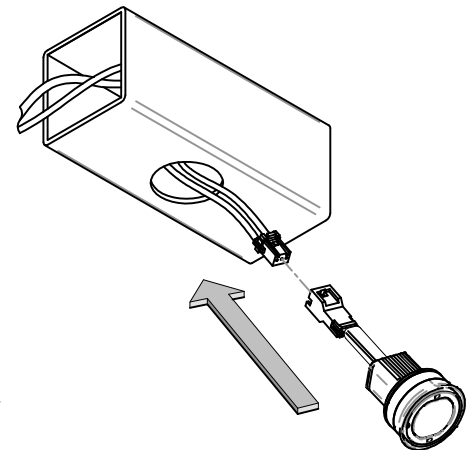

**8** CAREFULLY feed the Scotchloks to the left of the clasp and the driver to the right with the driver connector hanging out.

Proceed to connect the LEDPOD

## LEDPOD Removal Steps

**1** Insert removal tool into the 2mm holes in the LEDPOD

With firm pressure, rotate the LEDPod 90°

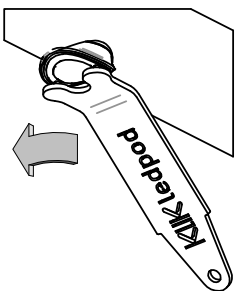

**2** Carefully peel back the IP silicone seal one side at a time.

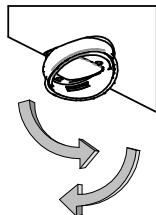

**3** Carefully remove the LEDPOD from the clasp, ensuring not to damage or disconnect wires in the process.

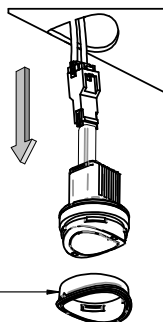

Be sure to re-attach the silicone seal ready for reinsertion.

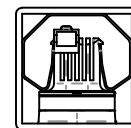

Light direction

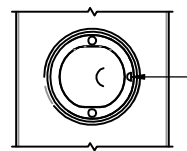

The notch indicates the direction of the light, Asymmetrical LEDPods

**9** Push LEDPOD in until it snaps into place and the outer surface is flush with the outer surface of the tube.

Prod the rim of the clear silicone IP Seal to provide a tighter fit.